

**REPLACEMENT LAYBY PLAN**

Mark	Revision	Date	Drawn	Chkd	Appd
H	AMENDED FOR CLIENT COMMENTS	16.07.21	CE	JH	NK
G	CYCLE TRANSITION ONTO POST HILL	14.07.21	CE	JH	NK
F	LAYBY RELOCATED AND BUS STOPS ADDED + TITLE REVISED	07.07.21	CE	JH	NK
E	EXTENT OF HMPPE UPDATED	24.09.20	SEL	NK	NK
D	AMENDED FOR CLIENT COMMENTS	15.07.20	SEL	NK	NT
C	AMENDED FOR CLIENT COMMENTS	13.07.20	SEL	NT	NT
B	REVISED VISI SPLAY	13.07.20	SEL	NK	NT
A	UPDATED ACCESS LOACTION	13.07.20	SEL	NK	NT

**FOR PLANNING**

**LAND AT HARTNOLL'S FARM,  
PROPOSED SITE ACCESS STRATEGY**

Client  
**WADDETON PARK LTD.**

Drawing Number  
**48582/5501/SK02**

Date of 1st Issue  
07.07.20

AT Scale  
1:500

Designed  
SEL

Checked  
NK

Drawn  
SEL

Approved  
NT

Revision  
H

**stantec.com/uk**

Copyright reserved  
The copyright in this drawing and any associated data shall be reproduced or used for any purpose other than that authorised by Stantec is forbidden.

TALANTON  
Tel: 01823 218 940

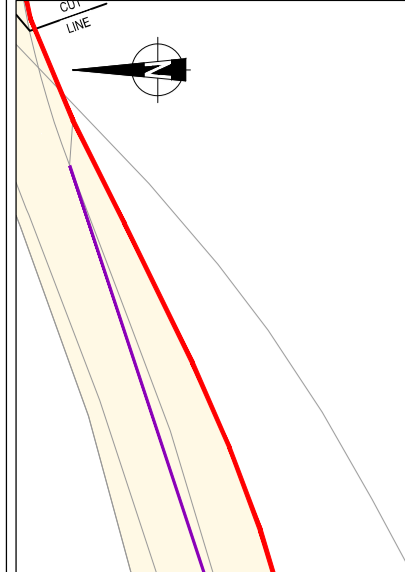

- NOTES:**
- THE LAYOUT IS SUBJECT TO DETAILED DESIGN, CAPACITY TESTING, GROUND INVESTIGATIONS RESULTS & EARTHWORKS MODELLING, UTILITIES & SERVICES AND CONFIRMATION OF LAND OWNERSHIP.
  - THE DETAILED DESIGN LAYOUT WILL BE DESIGNED IN ACCORDANCE WITH ALL RELEVANT DESIGN GUIDANCE AND STANDARDS.
  - THE LAYOUT HAS BEEN BASED ON THE APPROPRIATE DESIGN SPEED FOR OUR CURRENT PROPOSALS.
  - THIS DRAWING SHOULD BE READ IN CONJUNCTION WITH ALL RELEVANT ASSOCIATED DOCUMENTS.
  - THE USE OF THE DRAWING DOES NOT ABSOLVE THE CLIENT FROM THEIR RESPONSIBILITIES IN REGARDS TO HEALTH & SAFETY AND COM REGULATIONS.
  - THE DESIGN HAS BEEN BASED ON OS DATA AND THEREFORE REQUIRES CONFIRMATION WITH A TOPOGRAPHICAL SURVEY AND COMMENTS FROM THE LOCAL HIGHWAY AUTHORITY.
  - THE DESIGN HAS BEEN BASED ON OS DATA AND THEREFORE REQUIRES CONFIRMATION WITH A TOPOGRAPHICAL SURVEY AND COMMENTS FROM THE LOCAL HIGHWAY AUTHORITY.

- KEY:**
- HIGHWAY MAINTAINED AT PUBLICS EXPENSE AS PER DCC PLAN DATED 23/08/20
  - PROPOSED CARRIAGEWAY
  - PROPOSED FOOTWAY
  - PROPOSED VERGE
  - INDICATIVE RED LINE BOUNDARY (INTERPRETED FROM TITLE PLANS DMS65066 & DMS27688)
  - 4.5m x 120m VISIBILITY SPLAY (IN LINE WITH DMRB GUIDANCE FOR 40mph DESIGN SPEED)
  - 120m LAYBY VISIBILITY SPLAY (IN LINE WITH DMRB GUIDANCE FOR 40mph DESIGN SPEED)
  - 2.4m x 40m VISIBILITY SPLAY (IN LINE WITH MIS GUIDANCE FOR 30mph DESIGN SPEED)
  - 80m PEDESTRIAN CROSSING VISIBILITY (TRAFFIC SIGNS MANUAL CHAPTER 6)

